

***HJC***

# SMARTRO

SMART ROAD CYCLING HELMET

USER'S GUIDE

ENGLISH / Version 1.0.1

---

# BEFORE GETTING STARTED

## SMART HJC BT App

Download the SMART HJC BT App at Google Play Store or App Store.

### SMART HJC BT

- Quicker and easier setup and management.

## SMART HJC Device Manager

Download the SMART HJC Device Manager at [oem.sena.com/hjcsports/](http://oem.sena.com/hjcsports/).

### SMART HJC Device Manager

- Upgrade firmware.
- Configure settings.

## User's Guide in other languages

Download the User's Guide at [oem.sena.com/hjcsports/](http://oem.sena.com/hjcsports/).



HJC Corporation  
[www.hjchelmets.com](http://www.hjchelmets.com)

# CLICK ANY SECTION TO BEGIN



About the  
SMARTRO



Basic Operation



Smartphone  
Usage



Mesh Intercom



LED Taillight



Configuration  
Setting and  
Firmware Updates



Troubleshooting



Quick Reference



# 01 ABOUT THE SMARTRO

## Product Features

- LED Taillight
- Mesh Intercom™ 3.0 - delivers improved sound quality, a more robust connection, and extended talk time
- Dual version Mesh - Mesh 2.0 for backward compatibility
- Advanced Noise Control™
- Bluetooth® 5.2
- SMART HJC BT App
- Over-the-Air (OTA) Firmware Update

## Product Details

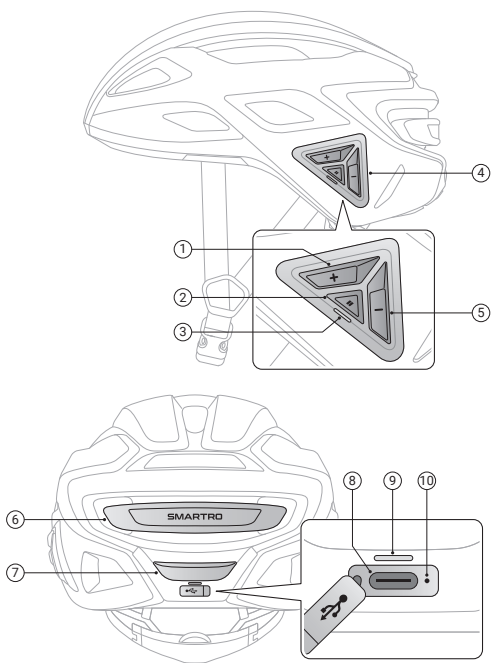

- 
- ① (+) Button

---

  - ② Multi-function Button

---

  - ③ Status LED

---

  - ④ Button Module

---

  - ⑤ (-) Button

---

  - ⑥ LED Taillight

---

  - ⑦ Light Button

---

  - ⑧ DC Power Charging & Firmware Upgrade Port

---

  - ⑨ Charging LED

---

  - ⑩ Pinhole Fault Reset Button
- 

---

## Package Contents

---

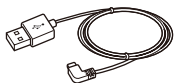

USB Power & Data Cable

---

## 02 BASIC OPERATION

### Legend

	<p>Tap Tap button the specified number of times</p>
	<p>Press and Hold Press and hold button for the specified amount of time</p>
	<p>Audible Prompt</p>
	<p>Blinking LED Taillight</p>

### Turn On

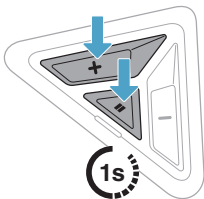

### Turn Off

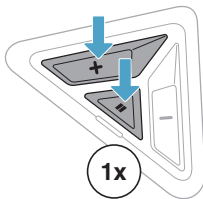

## Charging

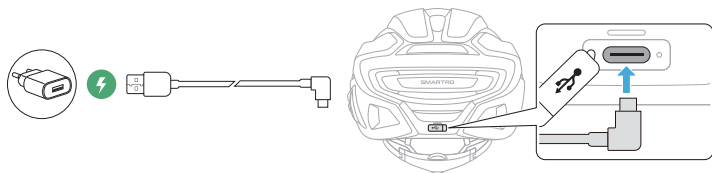

- It is recommended to take off the helmet before charging. The helmet will automatically turn off while charging.
- Any 3rd party USB charger can be used with HJC products if approved by FCC, CE, IC, or other locally approved agencies.
- Using a non-approved charger may cause fire, explosion, leakage, and other hazards which may also reduce the lifetime or performance of the battery.

## 03 SMARTPHONE USAGE

### Phone Pairing

1. There are three ways to enter the phone pairing mode.

- The first time you turn on the Bluetooth system:
  - The Bluetooth system will automatically enter the phone pairing mode when you initially turn it on or reboot it after executing a factory reset.

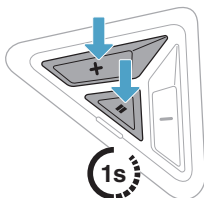

"Phone pairing"

- To cancel phone pairing, tap any button.

- Starting with your Bluetooth system powered off:

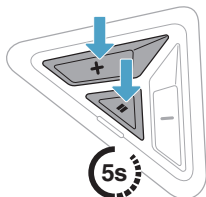

"Phone pairing"

- Starting with your Bluetooth system powered on:

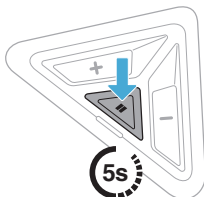

"Phone pairing"

2. Select **SMARTRO** in the list of Bluetooth devices detected.

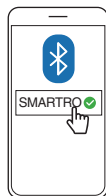

## Making and Answering Calls

### Answer a Call

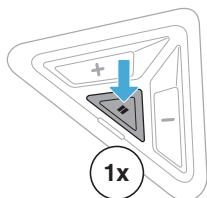

### End a Call

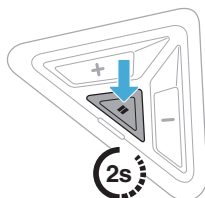

### Reject a Call

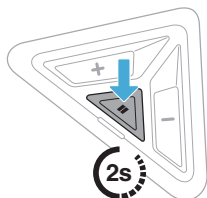

### Call a Voice Assistant

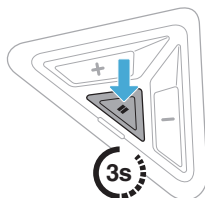

in stand-by mode

## Speed Dialling

### Assigning Speed Dial Presets

Speed Dial Presets can be assigned through the SMART HJC BT App and the SMART HJC Device Manager.

## Using Speed Dial Presets

1. Enter into the Speed Dial menu.

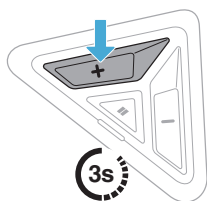

"Speed dial"

2. Navigate forward or backward through Speed Dial Preset numbers.

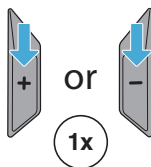

- ① Last number redial
- ② Speed dial (1→2→3)
- ③ Cancel

3. Tap the Multi-function Button to proceed.

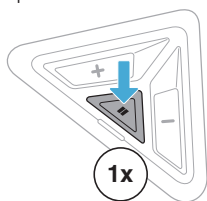

"Speed dial(#)"

---

## Music

---

### Play/Pause Music

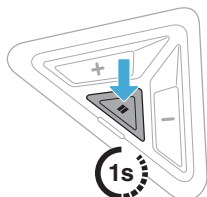

### Track Forward/Backward

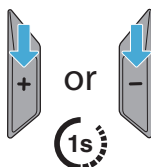

## 04 MESH INTERCOM

**Mesh Intercom** instantly provides effortless communication between users without a pre-grouping process. Freely communicate with virtually unlimited users in each of the 6 available channels.

### Switch to Mesh 2.0 for Backward Compatibility

Mesh 3.0 is the latest Mesh Intercom technology, but to communicate with legacy products using Mesh 2.0, please switch to Mesh 2.0 using the SMART HJC BT App.

### Mesh Intercom On/Off

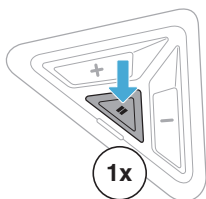

 **On:** "Mesh intercom on, channel 1"

 **Off:** "Mesh intercom off"

### Channel Setting

1. Enter into the Channel Setting.
2. Navigate between channels.

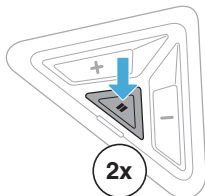

 "Channel setting, 1"

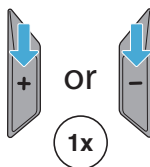

 "#"

### 3. Save the channel.

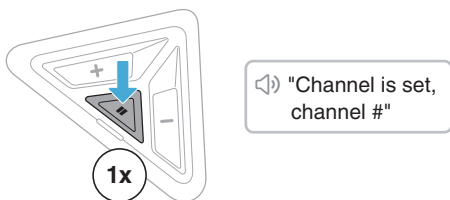

- Channel order: (1 → 2 → 3 ... → 6 → Exit → 1 → 2 ...)
- Channel Setting always starts with channel 1.
- To automatically save a channel after setting it, wait approximately 10 seconds before pressing any other buttons.
- The channel will be saved even if you turn off the SMARTRO.
- The SMART HJC BT App can also be used to change the channel.

## Mute/Unmute Mic (Default: Unmute)

Use the Multi-function Button to mute/unmute the microphone in any Mesh channel.

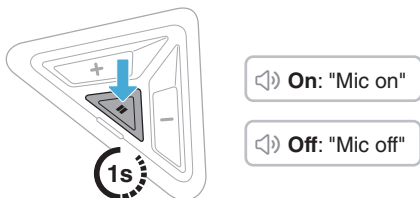

## 05 LED TAILLIGHT

### Change the light mode

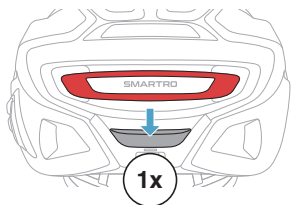

Light on and SOLID

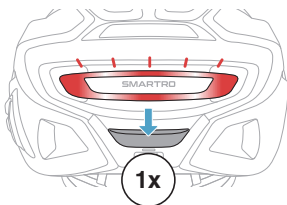

FADE

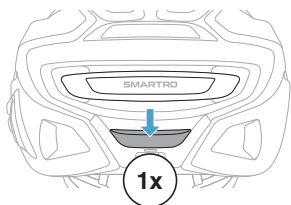

Light off

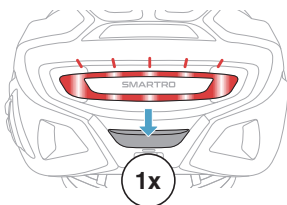

FLASH

## 06 CONFIGURATION SETTING AND FIRMWARE UPDATES

### Configuration Setting

You can change the configuration settings of the Bluetooth system through the SMART HJC BT App or the SMART HJC Device Manager.

#### SMART HJC BT

#### SMART HJC Device Manager

##### Headset Language

You can select or change the device language, which will stay saved even if the Bluetooth system is rebooted.

##### Voice Prompt (Default: Enabled)

While some Voice Prompts may be disabled in the software configuration settings, the following voice prompts are always on:

- Battery level indicator
- Speed dial
- Mesh Intercom

### Firmware Update

You can update the firmware via Over-the-Air (OTA) directly from the settings in the **SMART HJC BT App** or via the **SMART HJC Device Manager** by connecting the SMARTRO to your PC.

#### SMART HJC Device Manager



**Download Link** [oem.sena.com/hjcsports/](https://oem.sena.com/hjcsports/)

## 07 TROUBLESHOOTING

Please visit [oem.sena.com/hjcsports/](http://oem.sena.com/hjcsports/) for more troubleshooting information.

### Factory Reset

If you wish to erase all of your settings, the Bluetooth system can be restored to factory default settings using the **Factory Reset** feature.

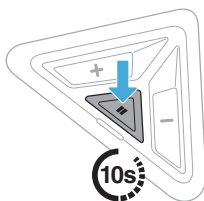

🔊 "Headset reset, good-bye"

### Fault Reset

If the Bluetooth system is not working properly, you can easily reset the unit:

1. Open the rubber cover of the DC Power Charging & Firmware Upgrade Port. There is the Pinhole Fault Reset Button next to the port.
2. Gently insert a paperclip into the hole and press the Pinhole Fault Reset Button with light pressure.

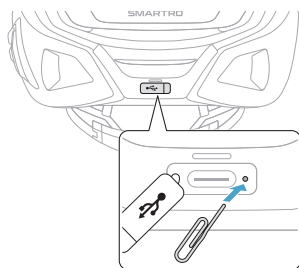

- Fault Reset will not restore the Bluetooth system to factory default settings.















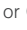



## 08 QUICK REFERENCE

 : (+) Button

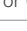
 : (-) Button

 : Light Button

 : Multi-function Button

Type	Operation	Button	Duration
<b>Basic Operations</b>	Turn on	 & 	Press 1 sec
	Turn off	 & 	Tap
	Volume up/down	 or 	Tap
<b>Phone Usage</b>	Answer phone call		Tap
	End phone call		Press 2 sec
	Reject phone call		Press 2 sec
	Call a Voice Assistant		Press 3 sec
	Speed dial		Press 3 sec
	Play/Pause music		Press 1 sec
	Track forward/back	 or 	Press 1 sec
<b>Mesh Intercom</b>	Mesh Intercom on/off		Tap
	Channel setting		Double tap
	Mute/Unmute Mic		Press 1 sec
<b>LED Taillight</b>	Change the light mode		Tap
<b>Factory Reset</b>			Press 10 sec