

# SENA

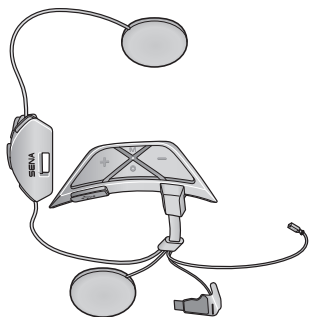

## **ABC**

MOTORCYCLE MESH COMMUNICATION SYSTEM  
FOR AVA ARROW HELMETS

**HD SPEAKERS**

QUICK START GUIDE

ENGLISH / 1.0.0

## Downloadable Software

Download the **Sena Motorcycles App** at **Huawei App Gallery**, **Tencent MyApp**, or **App Store**.



Sena Motorcycles

Download the following items at [oem.sena.com/ava](https://oem.sena.com/ava).



Sena Device Manager

- Firmware upgrade
- Device configuration setting



Quick Start Guide,  
User's Guide

## Product Details

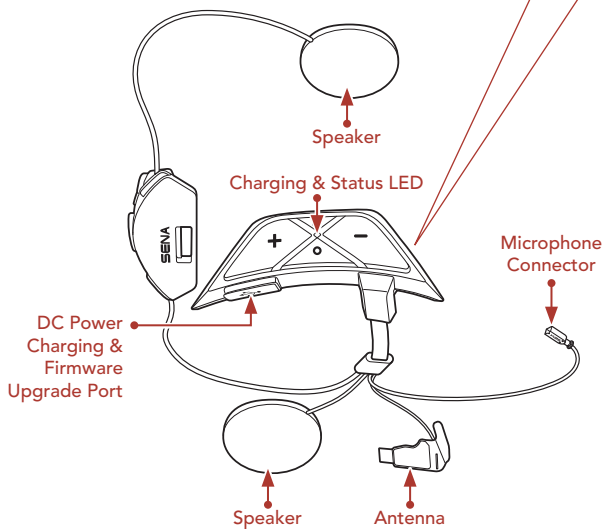
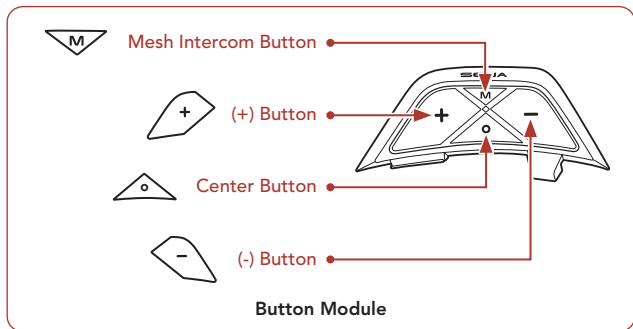

## Installation

- For more information about installation, refer to the User's Guide.

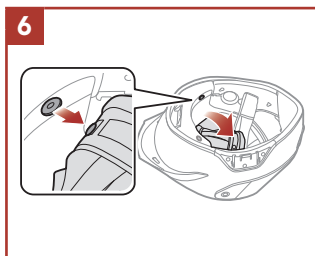
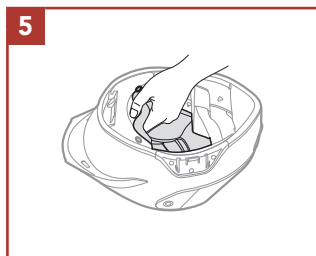
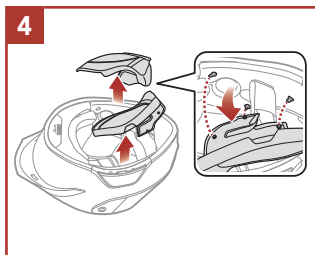
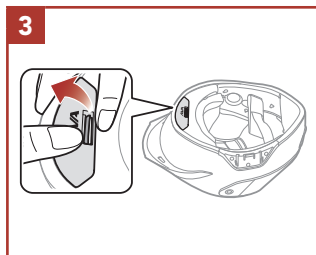
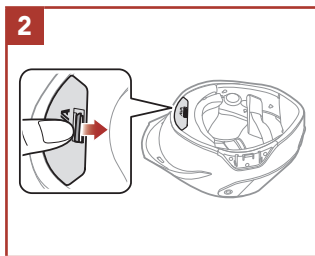
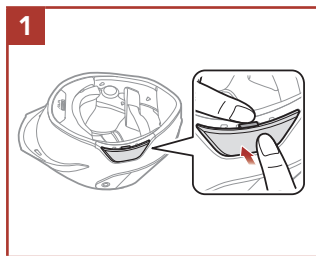

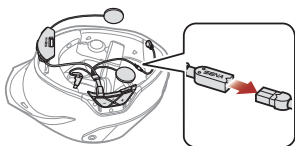
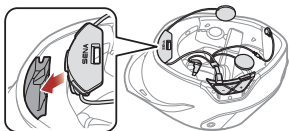
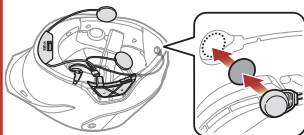
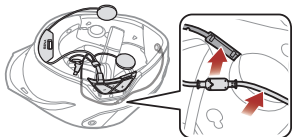
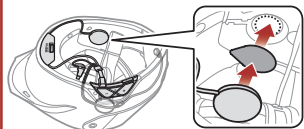
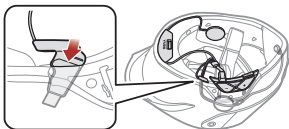
**7****8****9****10****11****12**

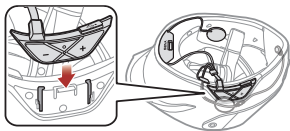
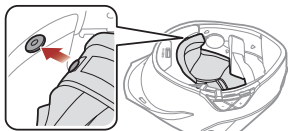
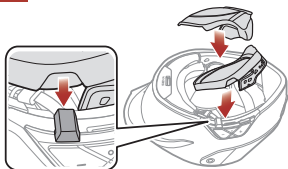
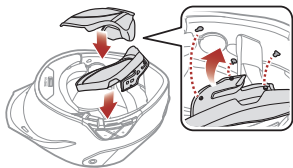
**13****14****15****16****17**

## Icon Legend

 Tap button the specified number of times

 Press and Hold button for the specified amount of time



"Hello"

Audible prompt

## Basic Operations

Powering On

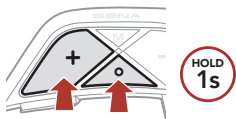

Powering Off

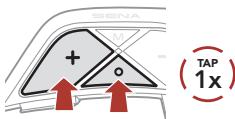

Volume Up

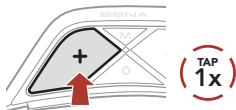

Volume Down

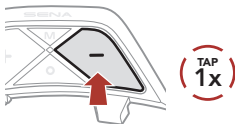

## Checking the Battery Level

Powering On

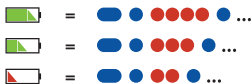

## ■ Phone Pairing



- ② Select **ABC** in the list of Bluetooth devices detected.

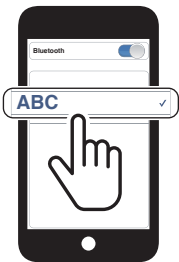

- The headset will enter the **Phone Pairing mode** automatically when you **initially turn on** the headset.
- For more information on phone pairing, refer to the User's Guide.



## Using the Phone

### Answer a Call

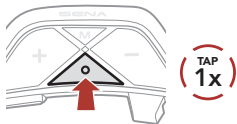

### End a Call

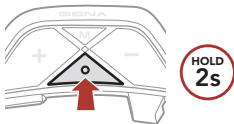

### Reject a call

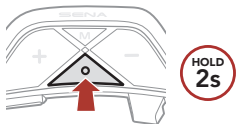

### Call a Voice Assistant



## Music Control

### Play/Pause

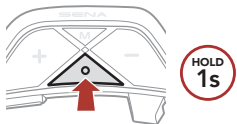

### Track forward

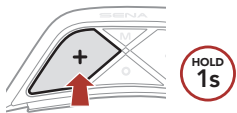

### Track backward

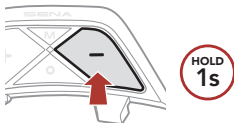

## Mesh Intercom™

**Open Mesh™:** communication within the same channel.

**Group Mesh™:** communication within the same private group.

- For more information on **Mesh Intercom**, refer to the User's Guide.

### Mesh Intercom On



Blinking 



"Mesh intercom on,  
Open Mesh, channel 1"

### Mesh Intercom Off

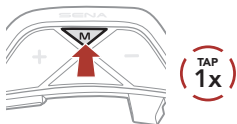

"Mesh intercom off"

**Note:** When **Mesh Intercom** is on, the **ABC** will automatically connect to nearby **ABC** users and the headset will be in **Open Mesh** (default: channel 1) initially.

## ■ Open Mesh

### Channel Setting (Default: channel 1) in Open Mesh

#### Using the Button

- ① Enter into the **Channel Setting**.



- ② Navigate between channels.  
(1 → 2 → ●●● → 8 → 9 → Exit → 1 → ●●●)

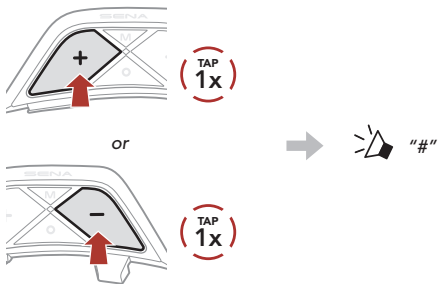

- ③ Save the channel.



#### Using the Sena Motorcycles App

You can select the channel through the **Sena Motorcycles App**.

# Group Mesh

**Group Mesh** is a closed group intercom function that allows users to join, leave, or rejoin a group intercom conversation without pairing each headset.

## 1) Creating a Group Mesh

Creating a **Group Mesh** requires **two or more Open Mesh users**.

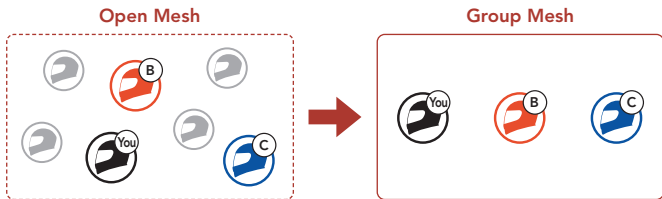

- ① **Users (You, B, and C)** enter into **Mesh Grouping** to create a **Group Mesh**.



- ② When **Mesh Grouping** is completed, the **users (You, B and C)** will hear a voice prompt on their headsets as **Open Mesh** switches to **Group Mesh**.



## 2) Joining an Existing Group Mesh

One of the **current users** in an **Existing Group Mesh** can allow **new users (one or more)** in **Open Mesh** to join the **Existing Group Mesh**.

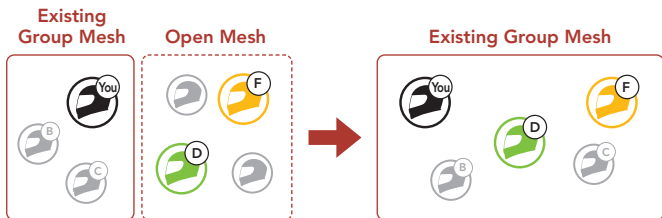

- ① One (**You**) of the **current users** in the **Existing Group Mesh** and **new users (D and F)** in **Open Mesh** enter into **Mesh Grouping** to join the **Existing Group Mesh**.



- ② When **Mesh Grouping** is completed, the **new users (D and F)** will hear a voice prompt on their headsets as **Open Mesh** switches to **Group Mesh**.



## ■ Enable/Disable Mic (Default: Enable)

Users can enable/disable the microphone when communicating in a **Mesh Intercom**.

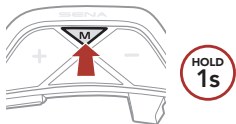

## ■ Reset Mesh

If a headset in an **Open Mesh** or **Group Mesh** resets the **Mesh**, it will automatically return to **Open Mesh (default: channel 1)**.

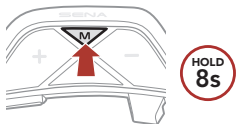

# ■ Configuration Menu

## Accessing the Configuration Menu



## Navigating Between Menu Options

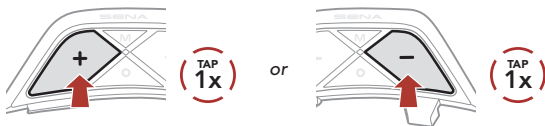

## Execute Menu Options

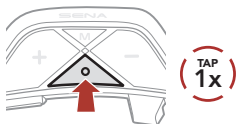

# Troubleshooting

## Factory Reset



## Fault Reset

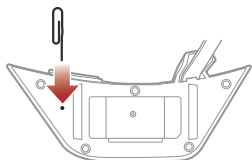









**Note:** Fault Reset will not restore the headset to the factory default settings.



## Quick Reference

TYPE	OPERATION	BUTTON COMMANDS
 Basic Operations	Power on / Power off	     
	Volume up / Volume down	 or  
 Mobile Phone	Answer phone call	 
	End phone call	 
	Reject phone call	 
	Call a Voice Assistant	 
 Music	Play/Pause music	 
	Track forward	 
	Track backward	 

TYPE	OPERATION	BUTTON COMMANDS
 <p data-bbox="106 438 231 485">Mesh Intercom™</p>	Mesh Intercom on/off	 
	Channel setting	 
	Mesh Grouping	 
	Reset Mesh	 
	Enable/Disable Mic	